

# INSTRUCTION

- It is important to clean both hands and your LCD screen before the installation procedure.
- Film may be useless, if some dust or fingerprint gets on the adhesive side of film.
- You might notice thin white lines on the adhesive side. In this case, do not be alarmed. It is not scratch nor dust and it will disappear after 24 hours of attachment.

## Check Film Size

Clean both hands and LCD screen and adjust the location where the film would be on the LCD before the procedure. (Please arrange the film to the center of LCD before you take off all vinyl out of the hard film.)

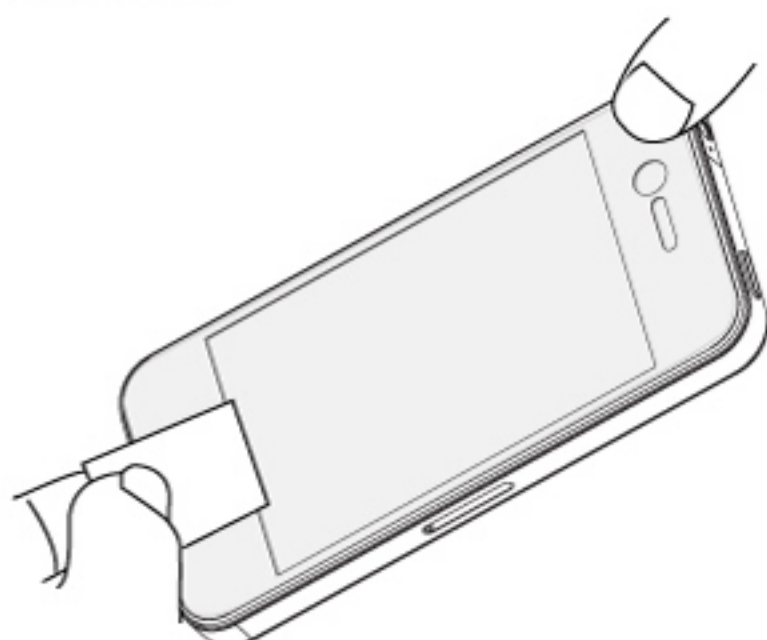

## Clean LCD

Clean the LCD with cleaner and micro fiber cloth included. If there is a dust left on the LCD, that can cause a bubble. Apply cleaner on the cloth, not on LCD.

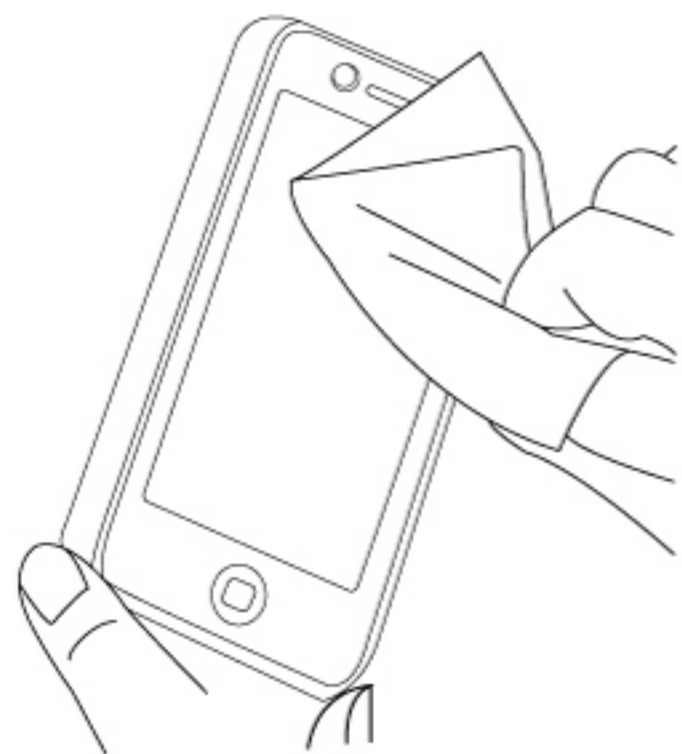

## Film Installation

Take off 1/3 of back vinyl and begin to apply it on the area you desired on LCD. Take off the rest of back vinyl as you fully attach the film. Result may vary upon installation.

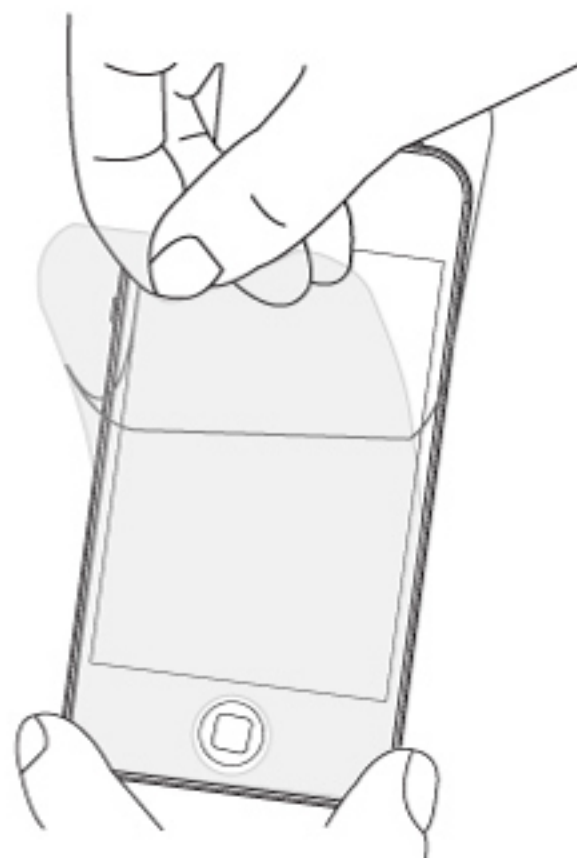

## Remove bubbles with a Squeeze

Remove bubbles by using squeegee included with the film. If you see bubbles after installation, lift up the film with a tape and re-attach it or slide the bubble to the sides very slowly and carefully with a squeeze.

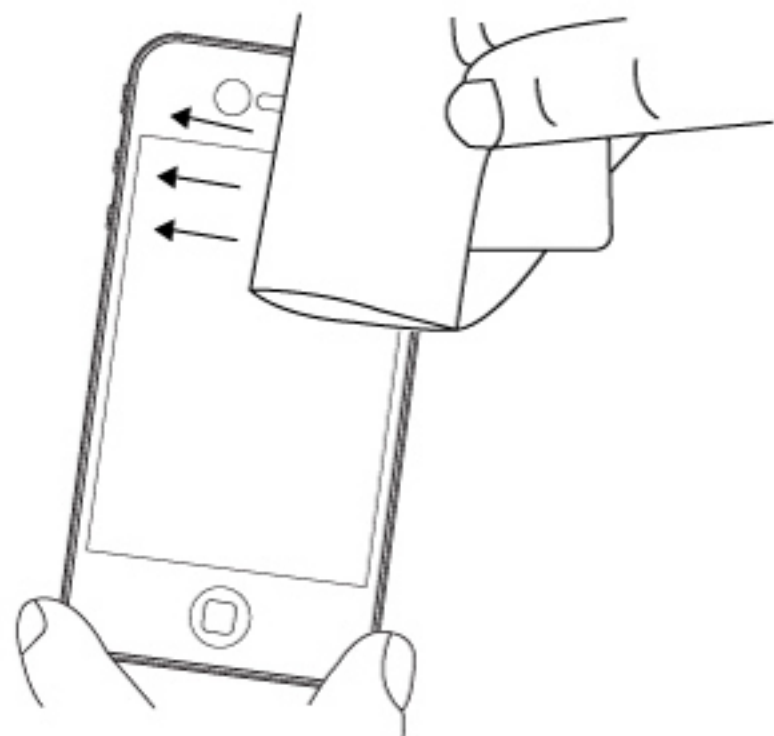

## ※In case of dust left underneath afterward

### Lifting the Film - Dust Removal

If you see any dust after installation, lift up a corner slowly with a tape, and remove dust.

Tape the corner of the film and slowly lift it up. Wrap the tape around the finger as picture advised, then tape the dusts away.

Be cautious not to allow dust inflows or sticky residue while removing the dust.

(It's better to use transparent tape which has weaker adhesiveness)

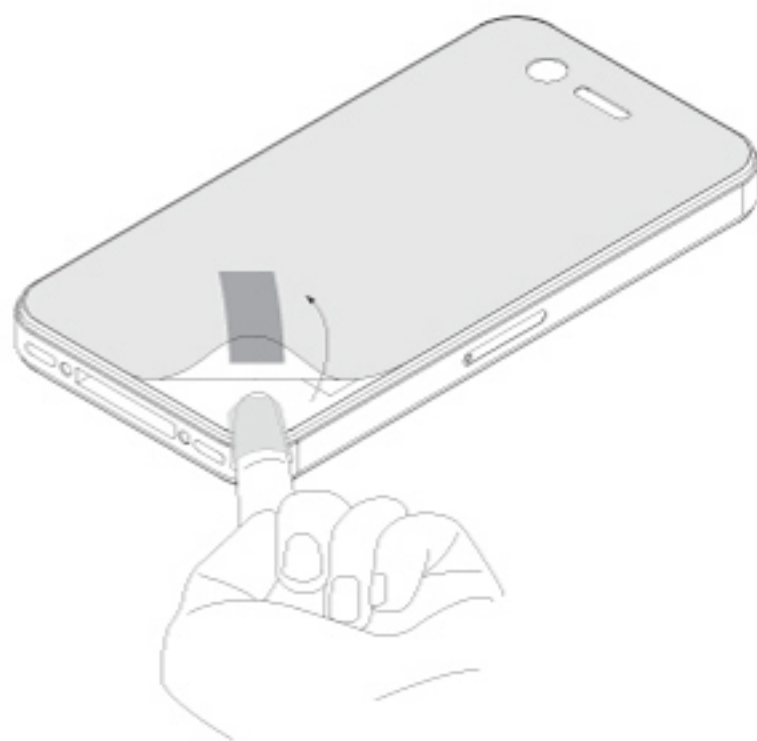

※ We do not responsible for failure of installation and will not be covered by warranty.